



Versol Electric Water Heaters

Water Heating & Cooling Solutions

Solar Water Heaters

Heat Exchangers

Storage Calorifiers

Heat Pump

Hot Water Boilers

Gas Fired Calorifiers

Electric Calorifiers

Steam Boilers



 Corporate offices

 Sales offices



Versol Poland | Versol Italy | Versol UK | Versol USA | Versol Middle East | Versol india



A5

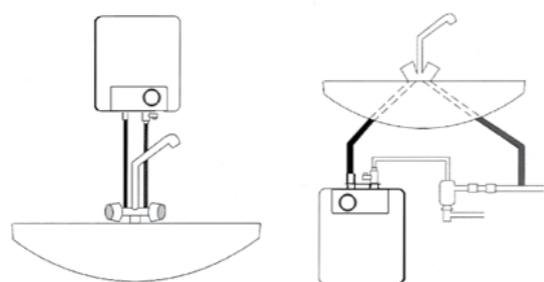
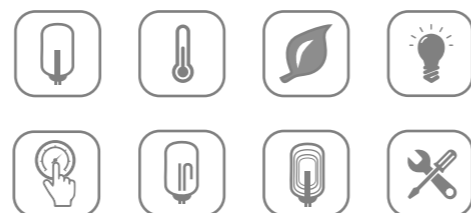
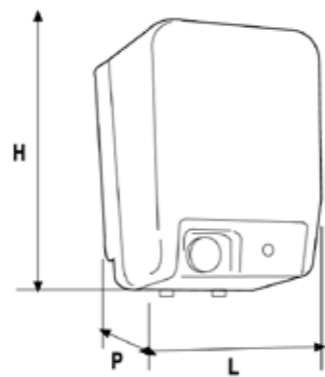

Models	H mm	L mm	P mm	
A5 SP	340	250	245	oversink
A5 ST	340	250	245	undersink

A12

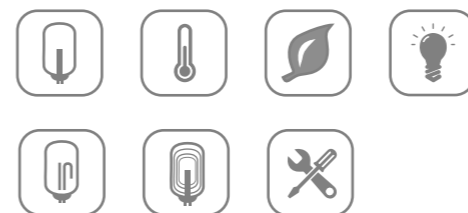
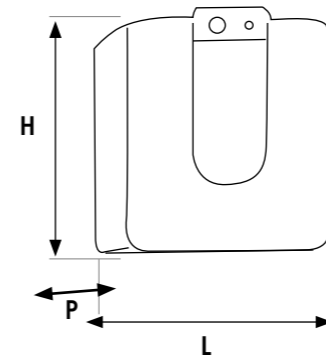

Models	H mm	L mm	P mm	
A12 SP	410	350	220	oversink
A12 ST	410	350	220	undersink

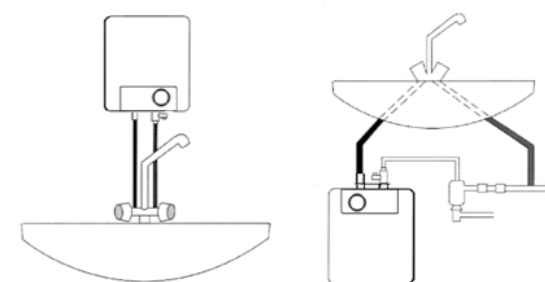

Models	Thermal Dispersion 65° (Kwh/24h)	Power Watts*	Voltage Volts	Heating Time dt 50°C	Max Temperature C°	Max Pressure (bar)	Humidity Protection	Class Insul.	Profile	Energy Class
A5	0,38	1500	230	16'	50	8	IPX4	I	XXS	B

Models	Thermal Dispersion 65° (Kwh/24h)	Power Watts*	Voltage Volts	Heating Time dt 50°C	Max Temperature C°	Max Pressure (bar)	Humidity Protection	Class Insul.	Profile	Energy Class
A12 SP	0,38	1500	230	30'	75	8	IPX4	I	XXS	B
A12 ST	0,38	1500	230	30'	75	8	IPX4	I	XXS	C



Q

12/15

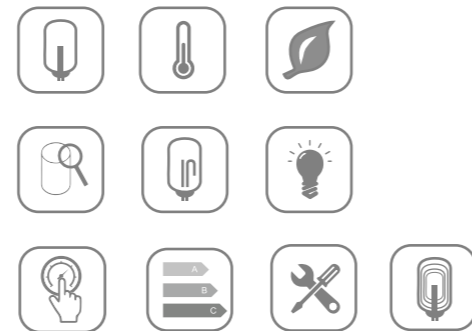
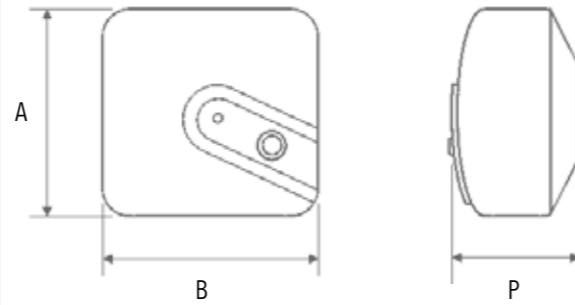

Models	A mm	B mm	P mm
Q12 SP	350	350	260
Q12 ST	350	350	260
Q15 SP	350	350	290
Q15 ST	350	350	290

Models	Thermal Dispersion 65° (Kwh/24h)	Power Watts*	Voltage Volts	Heating Time dt 50°C	Max Temperature C°	Max Pressure (bar)	Humidity Protection	Class Insul.	Profile	Energy Class
Q12 SP	0,38	1500	230	30'	55	8	IPX4	I	XXS	A
Q12 ST	0,38	1500	230	30'	65	8	IPX4	I	XXS	B
Q15 SP	0,42	1500	230	32'	65	8	IPX4	I	XXS	B
Q15 ST	0,42	1500	230	32'	65	8	IPX4	I	XXS	B

C 65

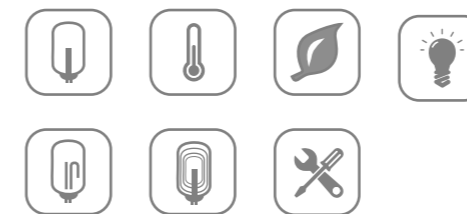
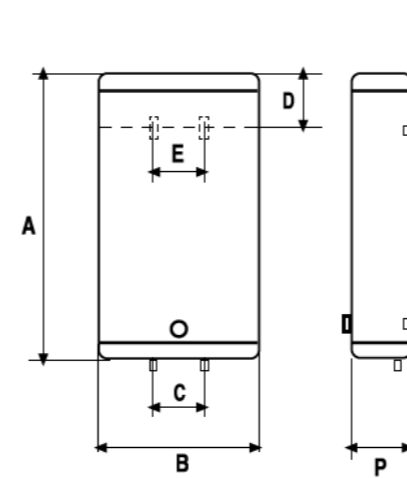

Models	A mm	B mm	C mm	D mm	E mm	P mm
C65	850	470	100	190	230	260

TWO TANKS AND TWO HEATING ELEMENTS

Models	Thermal Dispersion 65° (Kwh/24h)	Power Watts*	Voltage Volts	Heating Time dt 50°C	Max Temperature C°	Max Pressure (bar)	Humidity Protection	Class Insul.	Profile	Energy Class
C65	0,42	2x 1200	230	80'	50	8	IPX4	I	M	D



+ Product Skills

With two tanks, each one with its own element, it is possible to select using either one or both and halve the water heating time. See graphic of functions.



0 - Off
1 - Heating element on the left
2 - Element either side

B14

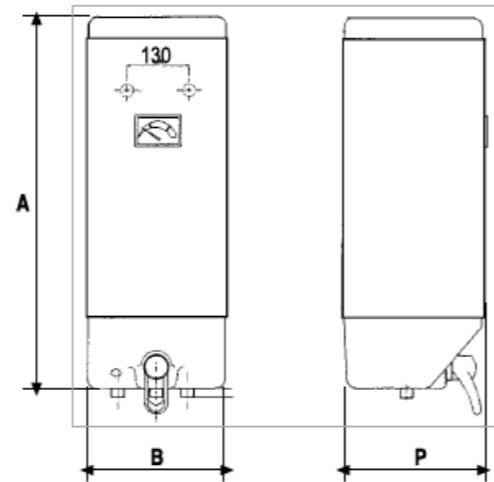

B30

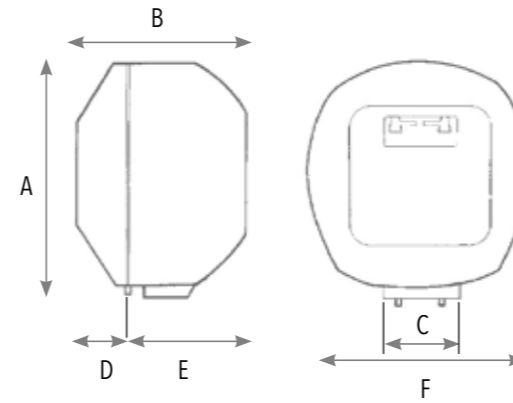

Models	A mm	B mm	P mm
B14	640	230	220

+ Product Skills

Mixer valve controls to regulate the flow of water.

Kit as standard include flexible tube and shower head with holder.

Double outlets to facilitate multiple hot water outlets.

Models	A mm	B mm	C mm	D mm	E mm	F mm
B 30	535	325	100	120	205	460

Models	Thermal Dispersion 65° (Kwh/24h)	Power Watts*	Voltage Volts	Heating Time dt 50°C	Max Temperature C°	Max Pressure (bar)	Humidity Protection	Class Insul.	Profile	Energy Class
B14	0,52	2000	230	26'	75	8	IPX4	I	XXS	B

Models	Thermal Dispersion 65° (Kwh/24h)	Power Watts*	Voltage Volts	Heating Time dt 50°C	Max Temperature C°	Max Pressure (bar)	Humidity Protection	Class Insul.	Profile	Energy Class
B 30	0,70	1500	230	75'	75	8	IPX4	I	S	C



SLIM

Vertical

20/30/45/60

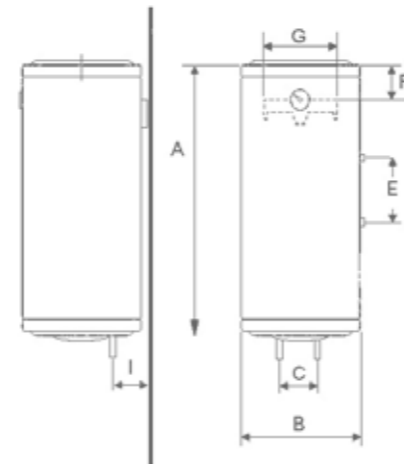

Models	A mm	B mm	C/E mm	F mm	G mm	I mm
SLIM 20	350	370	100	70	250	90
SLIM 30	450	370	100	70	250	90
SLIM 45	700	370	100	120	250	90
SLIM 60	850	370	100	120	250	90

+ Our objectif: SPACE SAVING

Our SLIM water heaters are our special answer to providing hot water where space is at a premium, with technology that always guarantees performances.

Models	Thermal Dispersion 65° (Kwh/24h)	Power Watts*	Voltage Volts	Heating Time dt 50°C	Max Temperature C°	Max Pressure (bar)	Humidity Protection	Class Insul.	Profile	Energy Class
SLIM 20	0,56	1200	230	64'	75	8	IPX4	I	S	C
SLIM 30	0,69	1200	230	75'	75	8	IPX4	I	S	C
SLIM 45	0,72	1200	230	110'	75	8	IPX4	I	M	D
SLIM 60	0,78	1200	230	150'	75	8	IPX4	I	M	D

SLIM

Horizontal

45/60

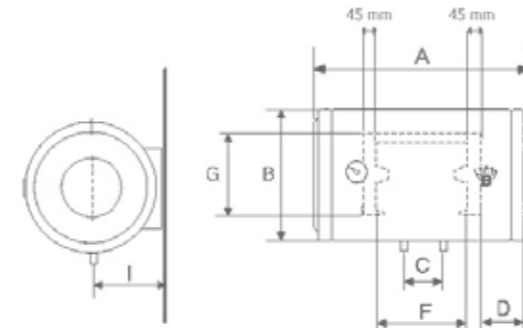

Models	A mm	B mm	C/E mm	F mm	G mm	I mm
SLIM 45	700	370	100	120	250	90
SLIM 60	850	370	100	120	250	90

Models	Thermal Dispersion 65° (Kwh/24h)	Power Watts*	Voltage Volts	Heating Time dt 50°C	Max Temperature C°	Max Pressure (bar)	Humidity Protection	Class Insul.	Profile	Energy Class
SLIM 45	0,79	1500	230	120'	75	8	IPX4	I	M	D
SLIM 60	0,86	1500	230	170'	75	8	IPX4	I	M	D





SE

50/80/100/
120/150/200

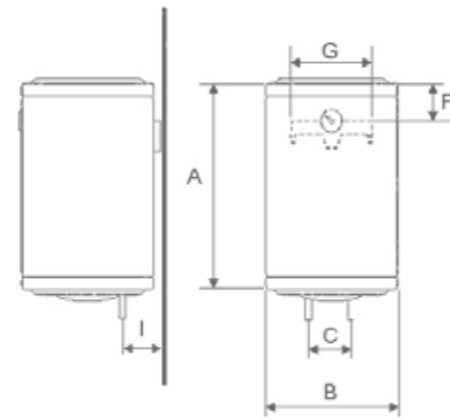

Available with
outer regulation
of temperature

Model	A mm	B mm	C mm	F mm	G mm	I mm
SE 50	510	460	100	130	350	130
SE 80	700	460	100	130	350	130
SE 100	805	460	100	130	350	130
SE 120	1000	460	100	130	350	130
SE 150	935	550	140	180	350	130
SE 200	1105	550	140	180	350	130

SO

50/80/100/120/
150/200

Available with right or left connections

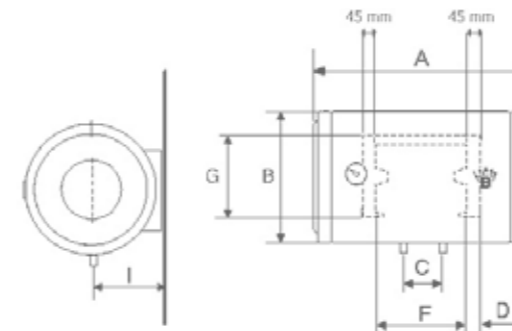

Model	A mm	B mm	C mm	D mm	F mm	G mm	I mm
SO 50	510	460	100	155	125	350	240
SO 80	700	460	100	145	330	350	240
SO 100	805	460	100	145	435	350	240
SO 120	1000	460	100	210	510	350	240
SO 150	935	550	140	210	450	350	285
SO 200	1105	550	140	190	640	350	285



Model	Thermal Dispersion 65° (Kwh/24h)	Power Watts*	Voltage Volts	Heating Time dt 50°C	Max Temperature C°	Max Pressure (bar)	Humidity Protection	Class Insul.	Profile	Energy Class
SE 50	0,98	1200	230	170'	75	8	IPX4	I	M	D
SE 80	1,32	1200	230	260'	75	8	IPX4	I	M	D
SE 100	1,51	1500	230	245'	75	8	IPX4	I	M	D
SE 120	1,84	1500	230	315'	75	8	IPX4	I	L	D
SE 150	2,09	2000	230	416'	75	8	IPX4	I	L	D
SE 200	2,41	2000	230	499'	75	8	IPX4	I	L	D

Model	Thermal Dispersion 65° (Kwh/24h)	Power Watts*	Voltage Volts	Heating Time dt 50°C	Max Temperature C°	Max Pressure (bar)	Humidity Protection	Class Insul.	Profile	Energy Class
SO 50	1,11	1500	230	170°	75	8	IPX4	I	M	D
SO 80	1,61	1500	230	260°	75	8	IPX4	I	M	D
SO 100	1,66	1500	230	245°	75	8	IPX4	I	M	D
SO 120	2,02	1500	230	315°	75	8	IPX4	I	L	D
SO 150	2,29	2000	230	416°	75	8	IPX4	I	L	D
SO 200	2,55	2000	230	499°	75	8	IPX4	I	L	D

*Power of the heating element is optional for the customers; they can use 1200-1500-2000 Watts.

Smart

SERIES

The Smart thermostat, thanks to new technologies, calculates daily requirements of warm water analyzing the consumptions and plans the water heating to reduce the losses of heat and optimize the availability of warm water.

+ DOUBLE INSULATION

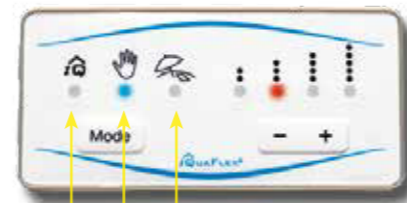
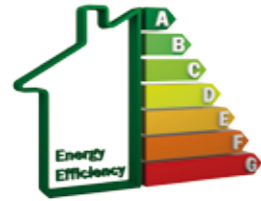

VACATION MODE:
for long periods of absence from home, select Vacation Mode

MANUAL MODE:
Water temperature is kept constant. You can set the temperature with the touch-panel.

SMART MODE:
You can choose between 4 different levels of Comfort

- CO₂

SMART

60/80/100

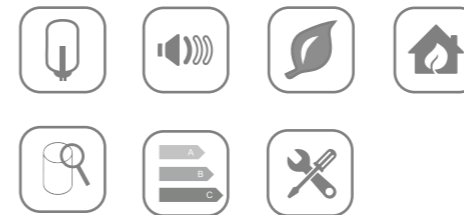
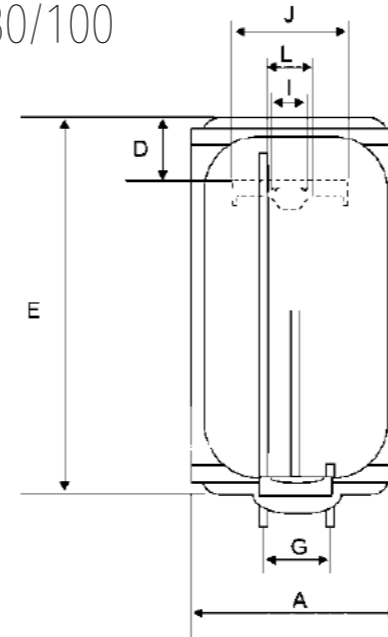

- + Easy to use
- + Memorise of water consumptions
- + Calculation of daily requirements based on the consumptions
- + Checking of the water heating phases to reduce the losses of heat and optimize the availability of warm water
- + Double insulation

Models	A mm	D mm	E mm	G mm	I mm	J mm	L mm
SMART 60	460	170	600	100	70	350	150
SMART 80	460	180	760	100	70	350	150
SMART 100	460	200	960	100	70	350	150

Models	Thermal Dispersion 65° (Kwh/24h)	Power Watts*	Voltage Volts	Heating Time dt 50°C	Max Temperature C°	Max Pressure (bar)	Humidity Protection	Class Insul.	Profile	Energy Class
SMART 60	0,79	1200	230	170'	65	8	IPX4	I	M	B
SMART 80	0,97	1200	230	260'	65	8	IPX4	I	M	B
SMART 100	1,18	1500	230	245'	65	8	IPX4	I	M	C



ST/STU

50-80-100-120-150-200

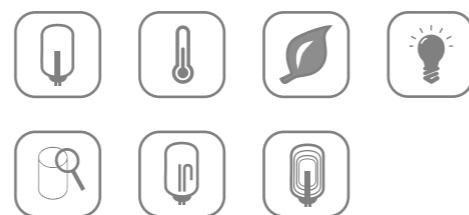
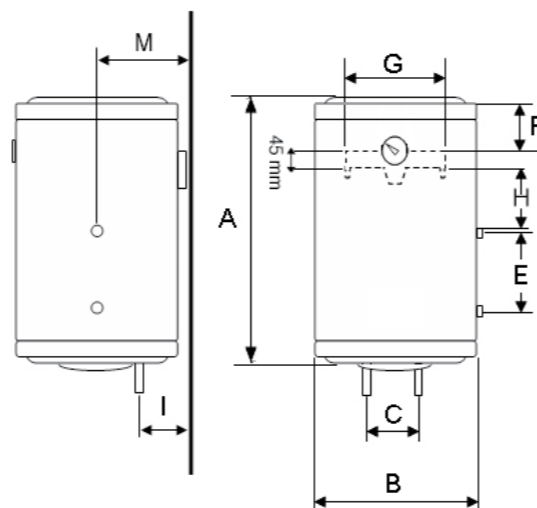

SO/T

80-100-120-150-200

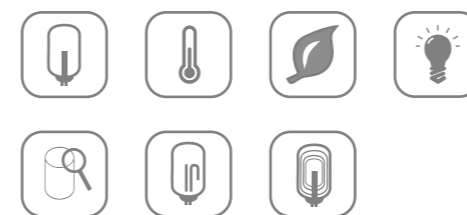
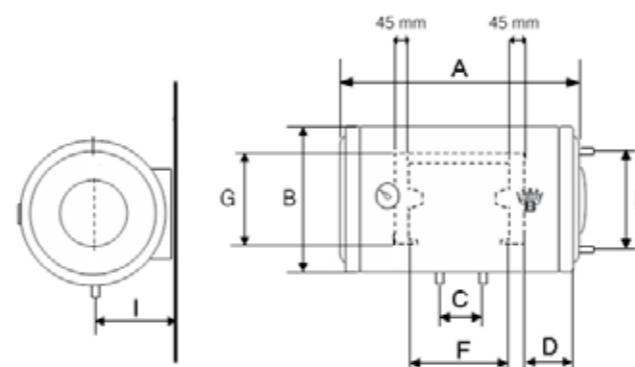

Models	A mm	B mm	C mm	E mm	F mm	G mm	H mm	I mm	M mm
ST 50	510	460	100	175	130	350	20	130	240
ST 80	700	460	100	265	130	350	40	130	240
ST 100	805	460	100	265	160	350	180	130	240
ST 120	1000	460	100	265	170	350	340	130	240
ST 150	935	550	140	350	180	350	140	130	285
ST 200	1105	550	140	350	180	350	280	130	285
STU 80	700	460	100	265	130	350		130	240
STU 100	805	460	100	265	160	350		130	240

Models	A mm	B mm	C mm	D mm	E mm	F mm	G mm	I mm
SO/T80	700	460	100	145	260	330	350	240
SO/T100	805	460	100	145	280	435	350	240
SO/T120	1000	460	100	210	280	510	350	240
SO/T150	935	550	140	207	365	450	350	285
SO/T200	1105	550	140	187	365	640	350	285

Models	Thermal Dispersion 65° (Kwh/24h)	Power Watts*	Voltage Volts	Heating Time dt 50°C	Max Temperature C°	Max Pressure (bar)	Humidity Protection	Class Insul.	Profile	Energy Class
ST 50	0,99	1200	230	170'	75	8	IPX4	I	M	D
ST 80	1,32	1200	230	260'	75	8	IPX4	I	M	D
ST 100	1,51	1500	230	245'	75	8	IPX4	I	M	D
ST 120	1,84	1500	230	315'	75	8	IPX4	I	L	D
ST 150	2,09	2000	230	416'	75	8	IPX4	I	L	D
ST 200	2,42	2000	230	500'	75	8	IPX4	I	L	D
STU 80	1,32	1200	230	260'	75	8	IPX4	I	M	D
STU 100	1,51	1500	230	245'	75	8	IPX4	I	M	D

Models	Thermal Dispersion 65° (Kwh/24h)	Power Watts*	Voltage Volts	Heating Time dt 50°C	Max Temperature C°	Max Pressure (bar)	Humidity Protection	Class Insul.	Profile	Energy Class
SO/T80	1,32	1500	230	260'	75	8	IPX4	I	M	D
SO/T100	1,51	1500	230	245'	75	8	IPX4	I	M	D
SO/T120	1,84	1500	230	315'	75	8	IPX4	I	L	D
SO/T150	2,09	2000	230	416'	75	8	IPX4	I	L	D
SO/T200	2,42	2000	230	500'	75	8	IPX4	I	L	D



ECO

60/80/100

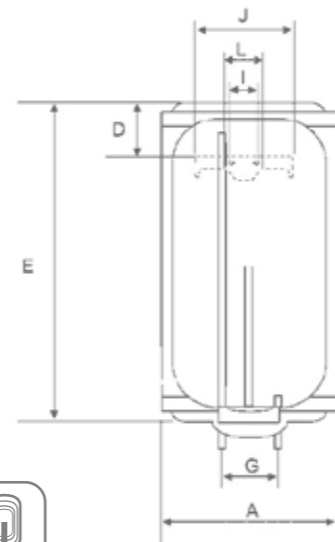

STX

80-100-120-150-200

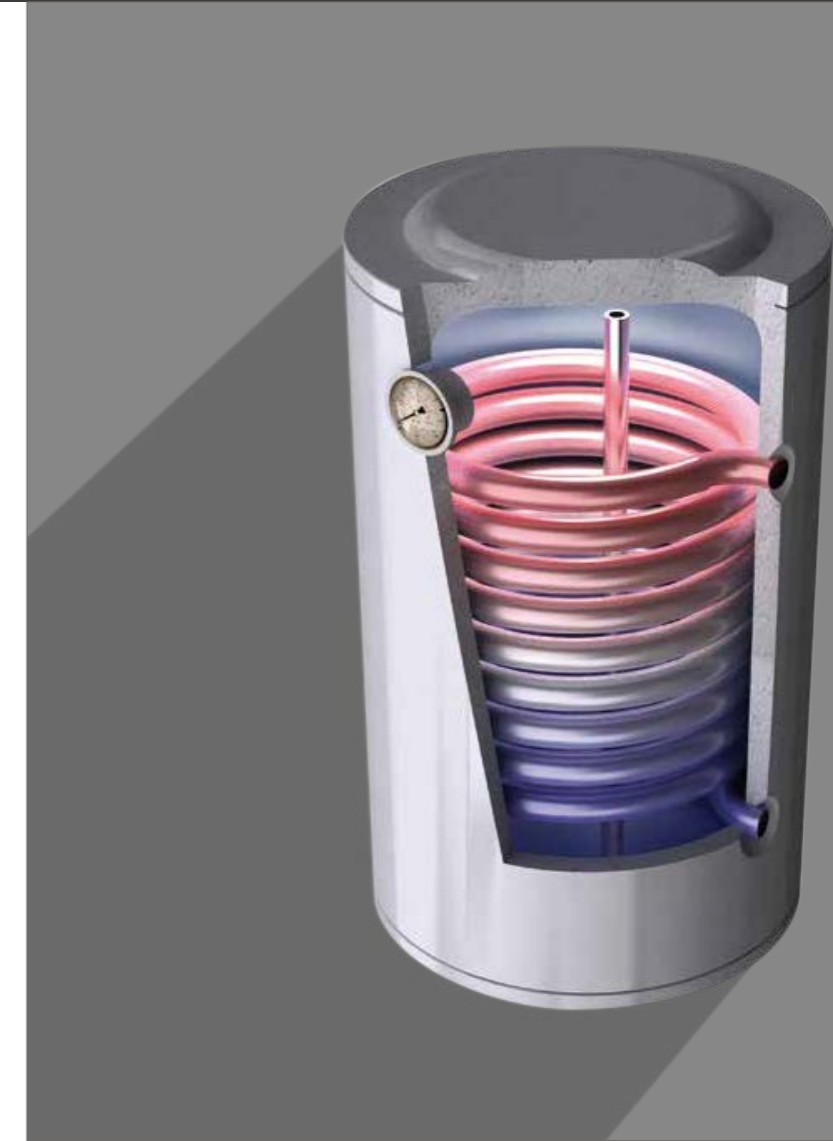
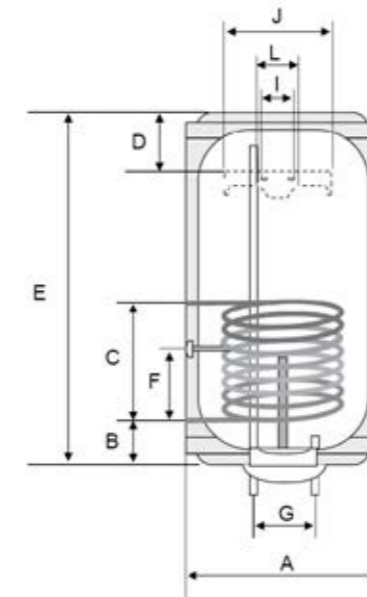

Models	A mm	D mm	E mm	G mm	I mm	J mm	L mm
ECO 60	460	170	600	100	70	350	150
ECO 80	460	180	760	100	70	350	150
ECO 100	460	200	960	100	70	350	150

- +** TOTAL PROTECTION AGAINST ELECTRO-MAGNETIC CORROSION USING MAGNESIUM ANODE
- +** TOTAL PROTECTION AGAINST RUSH
- +** ABSENCE OF CHLOROFLUOROCARBONE ECOLOGICAL POLYURETHANE FOAM FOR THERMAL INSULATION
- +** OUTER CASING FITTED WITH THERMAL RESISTANCE

Models	A mm	B mm	C mm	D mm	E mm	F mm	G mm	I mm	J mm	J mm
STX 80	460	185	265	130	700	135	100	70	350	150
STX 100	460	185	350	160	805	215	100	70	350	150
STX 120	460	185	350	170	1000	215	100	70	350	150
STX 150	550	247	350	180	935	130	140	70	350	150
STX 200	550	247	350	180	1105	130	140	70	350	150

Models	Thermal Dispersion 65° (Kwh/24h)	Power Watts*	Voltage Volts	Heating Time dt 50°C	Max Temperature C°	Max Pressure (bar)	Humidity Protection	Class Insul.	Profile	Energy Class
ECO 60	0,79	1200	230	170°	75	8	IPX4	I	M	C
ECO 80	0,97	1200	230	260°	75	8	IPX4	I	M	C
ECO 100	1,18	1500	230	245°	75	8	IPX4	I	M	C

Models	Thermal Dispersion 65° (Kwh/24h)	Power Watts*	Voltage Volts	Heating Time dt 50°C	Max Temperature C°	Max Pressure (bar)	Humidity Protection	Class Insul.	Profile	Energy Class
STX 80	1,32	1200	230	260'	75	8	IPX4	I	M	D
STX 100	1,51	1500	230	245'	75	8	IPX4	I	M	D
STX 120	1,84	1500	230	315'	75	8	IPX4	I	L	D
STX 150	2,09	2000	230	416'	75	8	IPX4	I	L	D
STX 200	2,42	2000	230	500'	75	8	IPX4	I	L	D

SL/SX/SZ

80

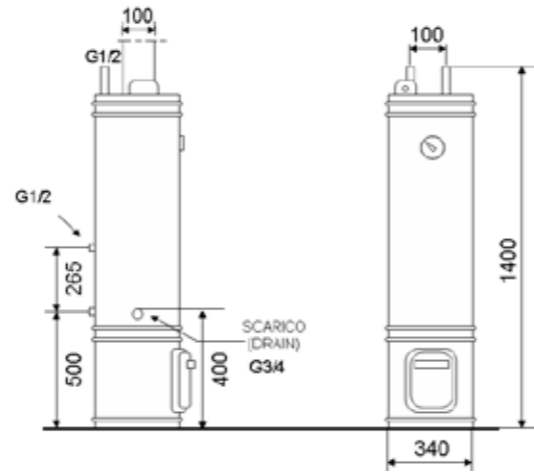

Packaging



Q-B-C mm

A-5	290x400x260
Q-12	397x392x296
Q-15	420x310x300
B-30	110x255x260
B-14	710x255x260
C-65	890x520x335

ECO - SMART mm

60 LT	695x470x490
80 LT	855x470x490
100 LT	1055x470x490

SE-SO-ST-STU-STX-SO/T mm

20 LT	410x410x460
30 LT	410x410x550
50 LT	590x480x500
80 LT	780x480x500
100 LT	900x480x500
120 LT	1100x480x500
150 LT	1060x575x575
200 LT	1260x575x575

SLIM mm

SLIM 45 V/H	410x410x780
SLIM 60 V/H	410x410x970

WOOD mm

(SL-SX-SZ)	380x380x1450
-------------------	--------------

+ SL=Wood water heater

+ SX= Wood water heater fitted with electric heating element and thermostat for connection to power supply.

+ SZ=Wood water heater fitted with electric heating element and thermostat for connection to power supply and heat exchanger coil for connection to the central heating system.

Models	Power of heat exchanger Kw eff ΔT 35°C	Power Watts*	Voltage Volts	Surface of heat exchanger SQM	Max Temperature C°	Max Pressure (bar)	Humidity Protection	Class Insul.
SL 80					75	8	IPX4	I
SX 80		1200	230		75	8	IPX4	I
SZ 80	8,1	1200	230	0,26	75	8	IPX4	I

