



INSTRUCTIONS BOOKLET
FOR INSTALLATION, USE AND MAINTENANCE

SOLAR HOT WATER
HEATING SYSTEM

SOLAR HOT WATER HEATING SYSTEM



Dear Customer

Thank you for choosing a Solar Hot Water Heating System by VERSOL GROUP.
In your interest and to maintain the highest level of performance and duration of your appliance, we recommend that you follow the instructions contained in this booklet and have regular maintenance performed by qualified personnel.
We would like to remind you that failure to follow the instructions contained in this booklet may invalidate the guarantee.

CE 0085

CONTENTS

GENERAL INSTRUCTIONS

PANEL FIXING DETAILS	PAGE-03-07
SOLAR PANEL FRAME INCLINATION	PAGE-08
PANEL INLET ASSEMBLY	PAGE-09
PANEL OUTLET ASSEMBLY	PAGE-10
PANEL TO PANEL ASSEMBLY	PAGE-11
PANEL SENSOR CONNECTION	PAGE-12
SOLAR CIRCULATION PUMP ASSEMBLY	PAGE 13
EXPANSION VESSEL ASSEMBLY	PAGE 14
EXPANSION VESSEL WITH PRE-COOL TANK	PAGE 15
ASSEMBLY EMERGENCY COOLER TANK ASSEMBLY	PAGE 16
FEEDER LINE ASSEMBLY	PAGE 17
CALORIFIER CONNECTIONS	PAGE 18

2 SOLAR PANEL IN ONE BANK (FPKIT-2) (Distance Between Panel to Panel with Valve & Accessories BOQ)

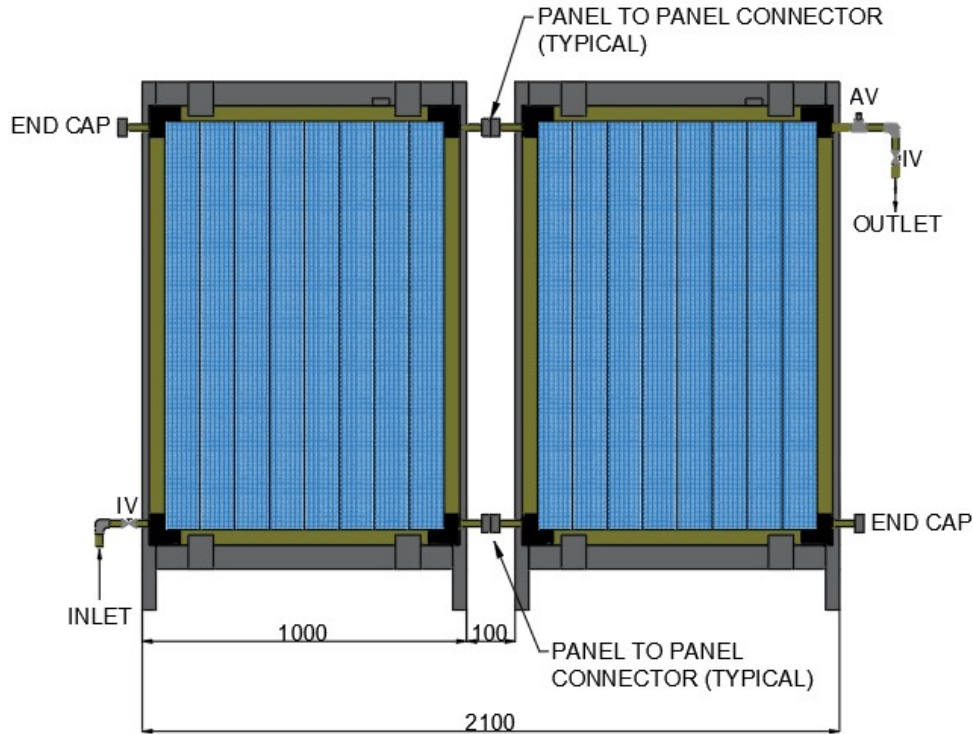

Number of Solar Panel		02 Nos	
Number of Solar Panel Frame		02 Nos	
End Cap 22mm		02 Nos	
SOLAR PANEL INLET			
SR. NO.	ITEM	SIZE	QTY
1	Isolation Valve	3/4"	1
2	Connector Kit	3/4"	1
PANEL TO PANEL KIT			
1	Panel to Panel Connector	3/4"	2
SOLAR PANE OUTLET			
1	Airvent	1/2"	1
2	Isolation Valve	3/4"	1

3 SOLAR PANEL IN ONE BANK (FPKIT-3) (Distance Between Panel to Panel with Valve & Accessories BOQ)

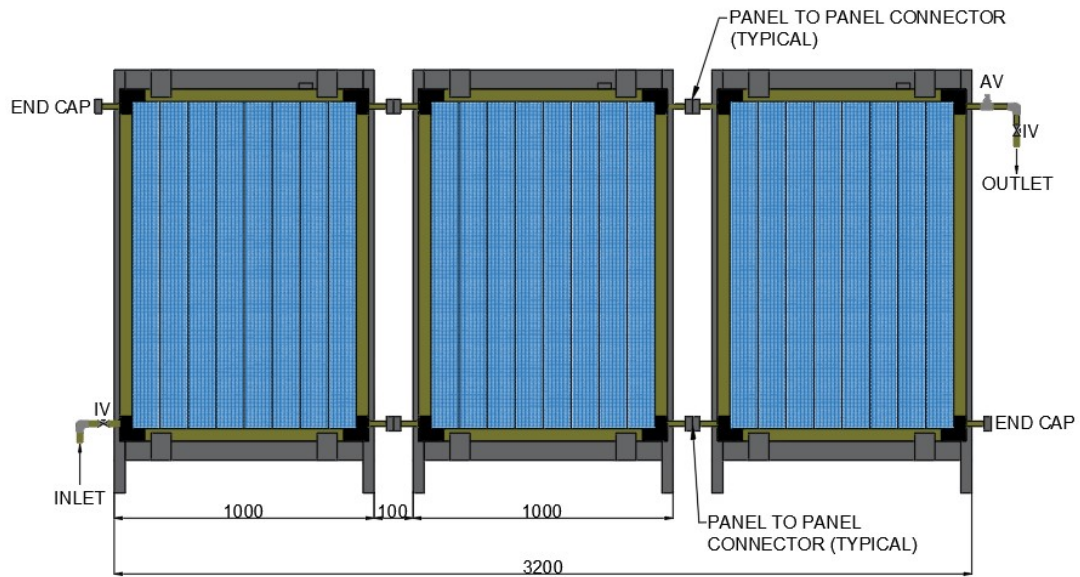

Number of Solar Panel		03 Nos	
Number of Solar Panel Frame		03 Nos	
End Cap 22mm		02 Nos	
SOLAR PANEL INLET			
SR. NO.	ITEM	SIZE	QTY
1	Isolation Valve	3/4"	1
2	Connector Kit	3/4"	1
PANEL TO PANEL KIT			
1	Panel to Panel Connector	3/4"	4
SOLAR PANE OUTLET			
1	Airvent	1/2"	1
2	Isolation Valve	3/4"	1

**4 SOLAR PANEL IN ONE BANK (FPKIT-4)
(Distance Between Panel to Panel with Valve & Accessories BOQ)**

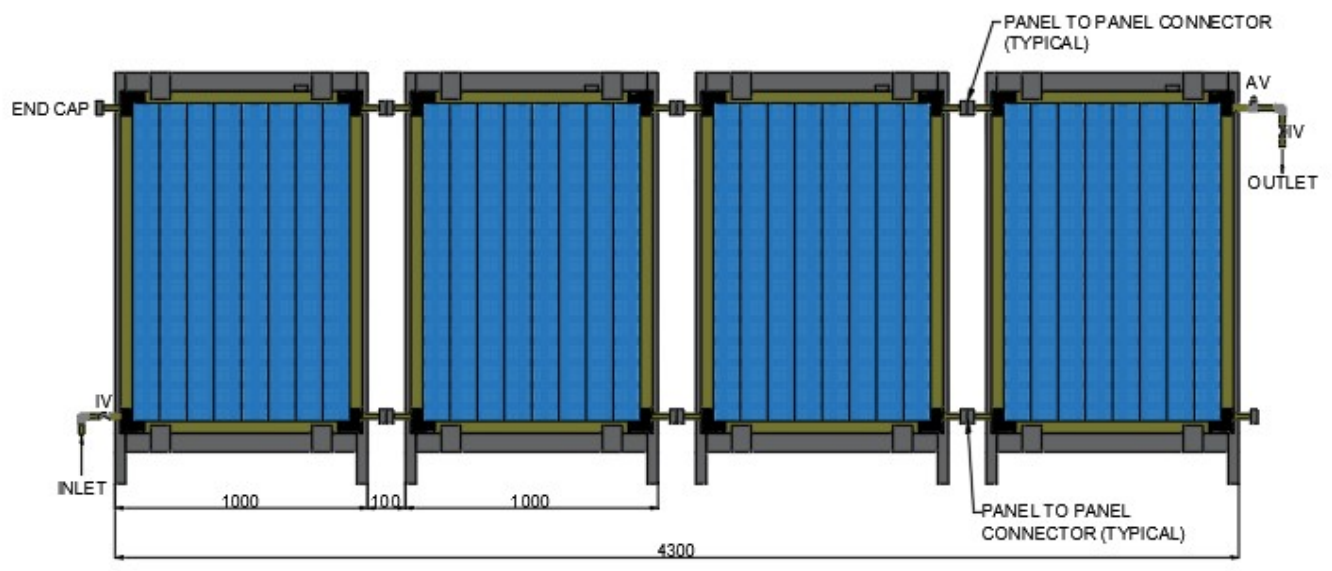

Number of Solar Panel	04 Nos		
Number of Solar Panel Frame	04 Nos		
End Cap 22mm	02 Nos		
SOLAR PANEL INLET			
SR. NO.	ITEM	SIZE	QTY
1	Isolation Valve	3/4"	1
2	Connector Kit	3/4"	1
PANEL TO PANEL KIT			
1	Panel to Panel Connector	3/4"	6
SOLAR PANEL OUTLET			
1	Airvent	1/2"	1
2	Isolation Valve	3/4"	1

5 SOLAR PANEL IN ONE BANK (FPKIT-5) (Distance Between Panel to Panel with Valve & Accessories BOQ)

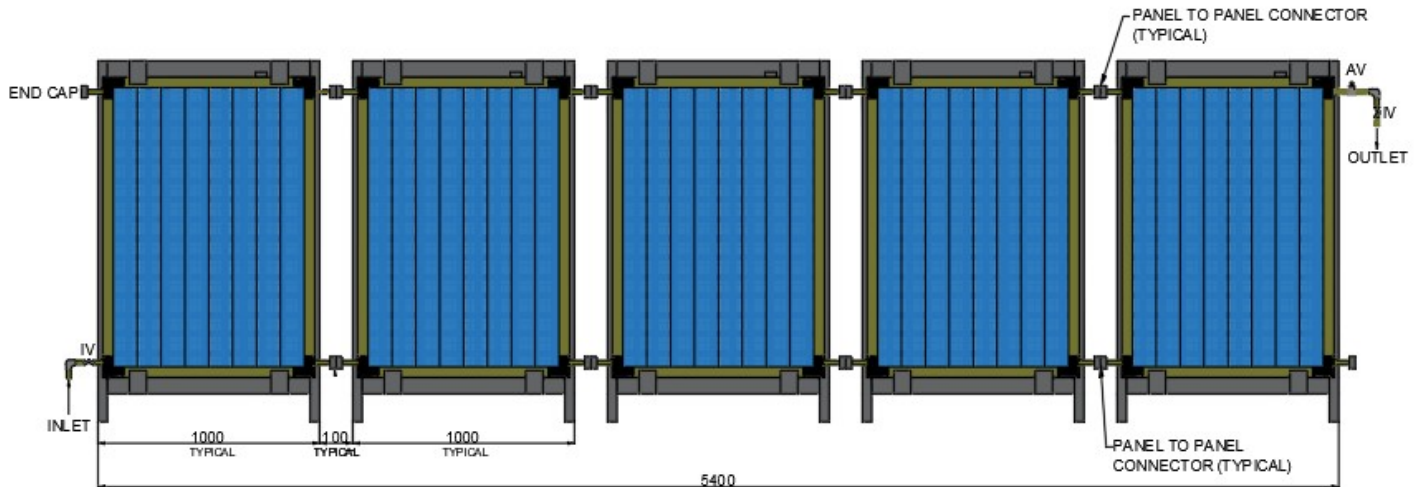

Number of Solar Panel		05 Nos	
Number of Solar Panel Frame		05 Nos	
End Cap 22mm		02 Nos	
SOLAR PANEL INLET			
SR. NO.	ITEM	SIZE	QTY
1	Isolation Valve	3/4"	1
2	Connector Kit	3/4"	1
PANEL TO PANEL KIT			
1	Panel to Panel Connector	3/4"	8
SOLAR PANEL OUTLET			
1	Airvent	1/2"	1
2	Isolation Valve	3/4"	1

**6 SOLAR PANEL IN ONE BANK (FPKIT-6)
(Distance Between Panel to Panel with Valve & Accessories BOQ)**

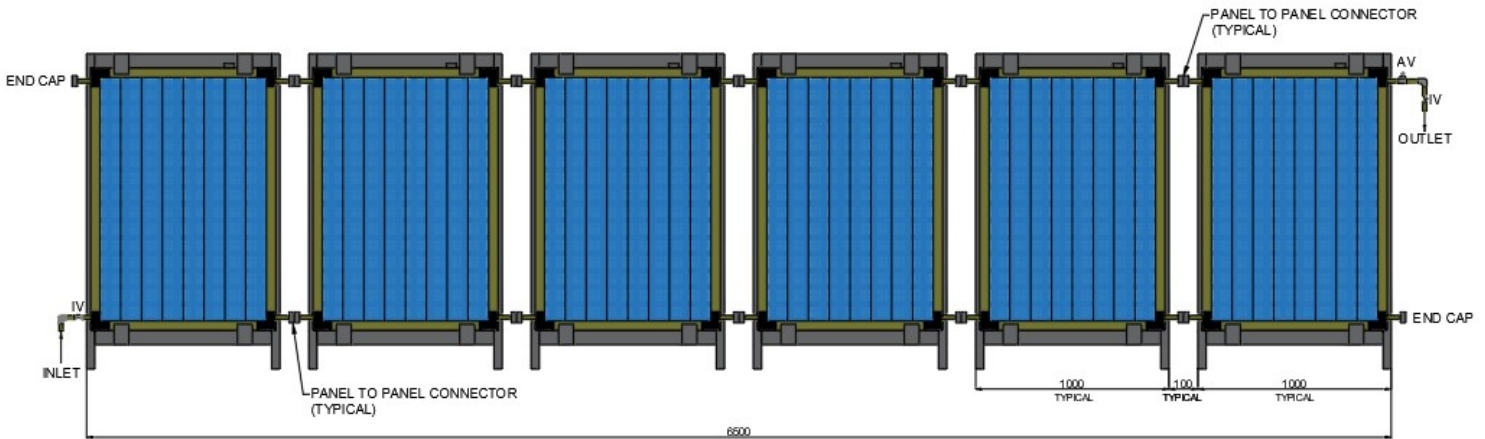

Number of Solar Panel		06 Nos	
Number of Solar Panel Frame		06 Nos	
End Cap 22mm		02 Nos	
SOLAR PANEL INLET			
SR. NO.	ITEM	SIZE	QTY
1	Isolation Valve	3/4"	1
2	Connector Kit	3/4"	1
PANEL TO PANEL KIT			
1	Panel to Panel Connector	3/4"	10
SOLAR PANEL OUTLET			
1	Airvent	1/2"	1
2	Isolation Valve	3/4"	1

Solar Panel Frame Angle of Inclination

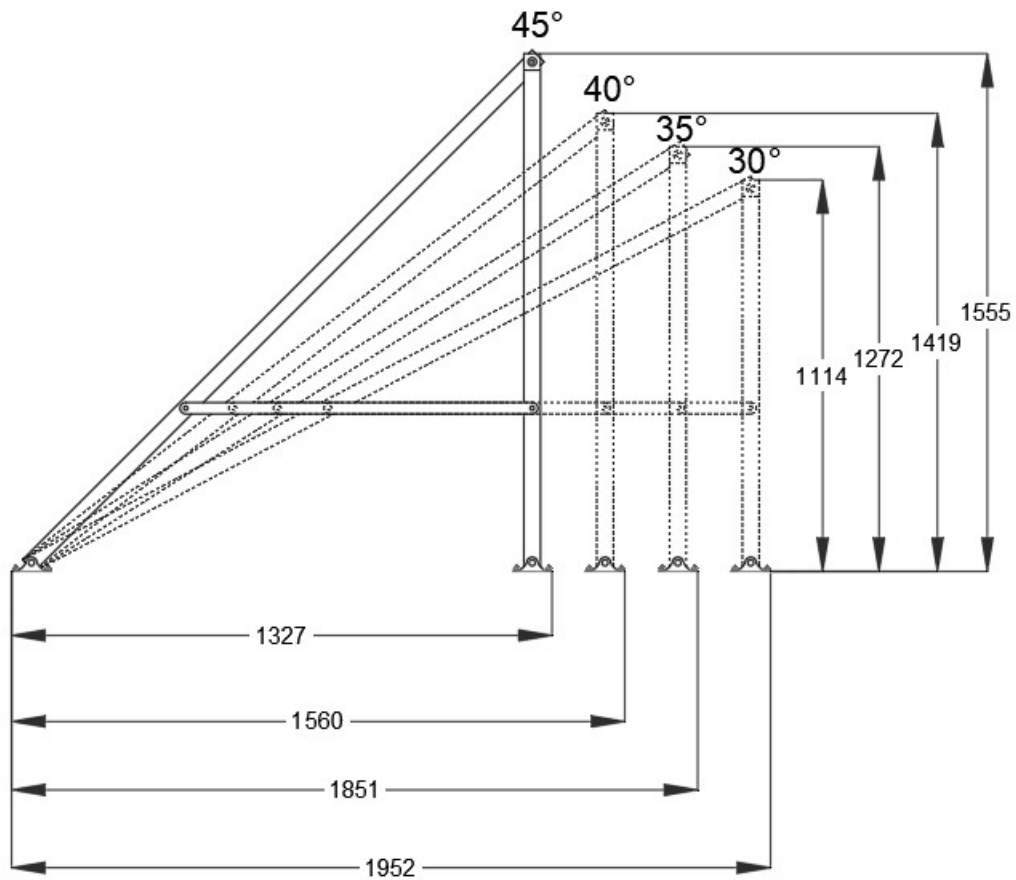

SOLAR PANEL INLET ASSEMBLY

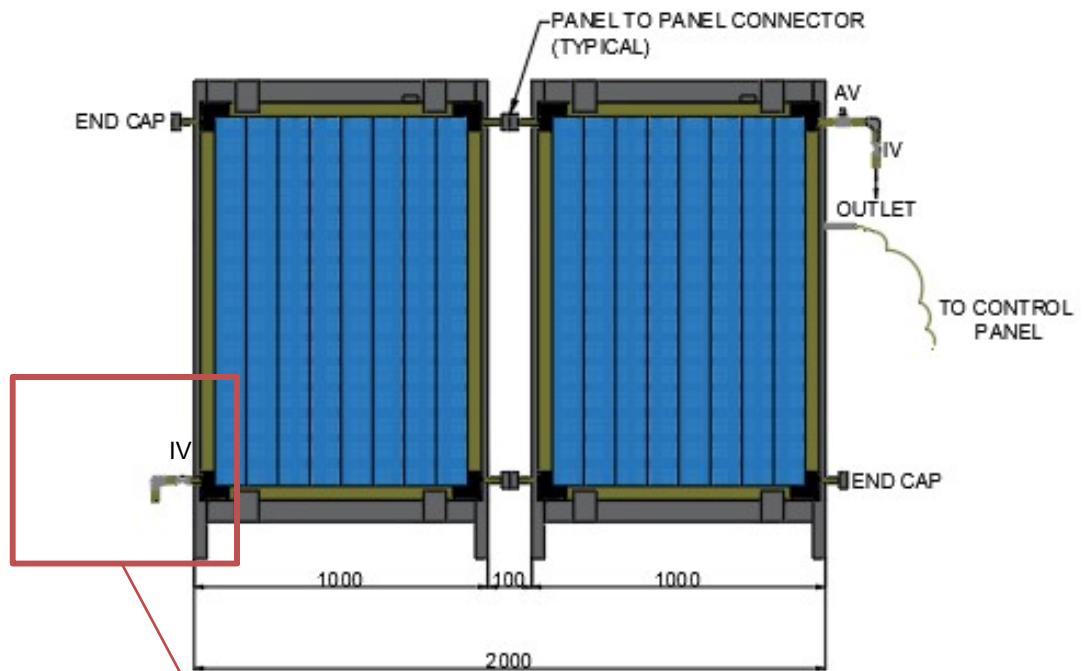

SOLAR PANEL OUTLET ASSEMBLY

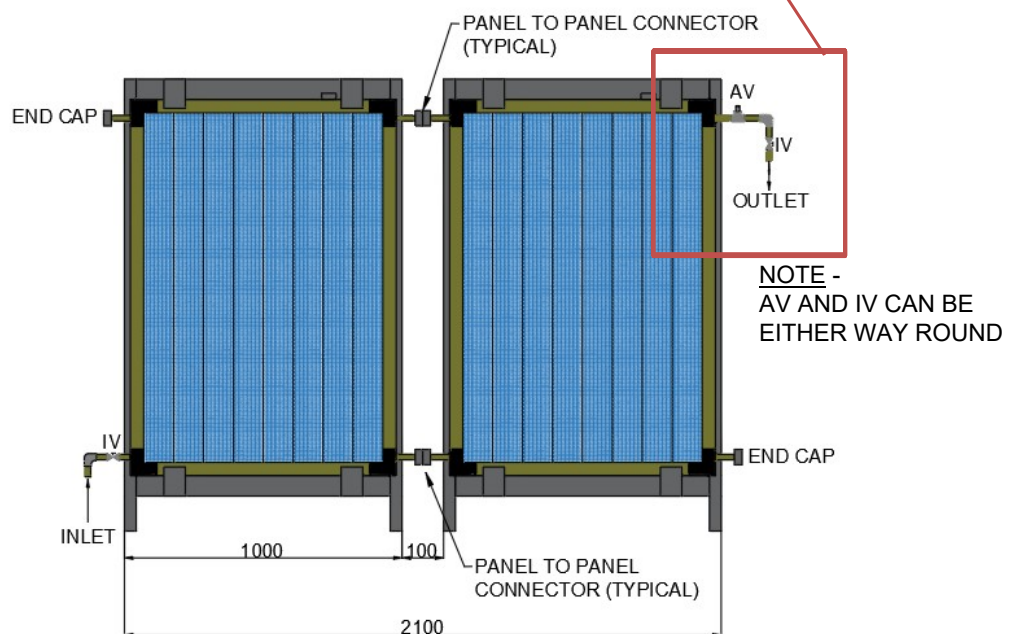

SOLAR PANEL TO PANEL ASSEMBLY KIT

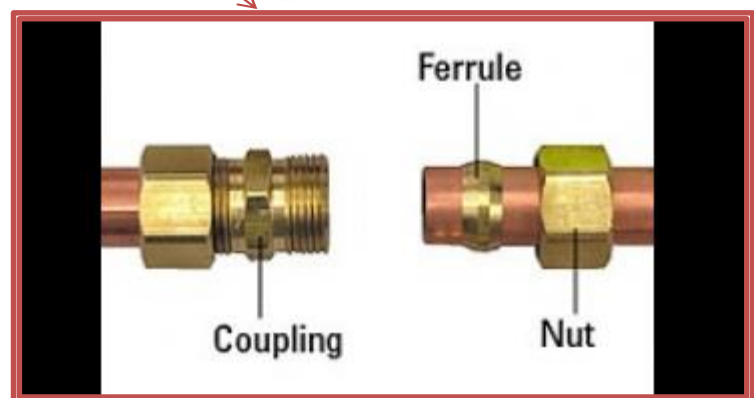
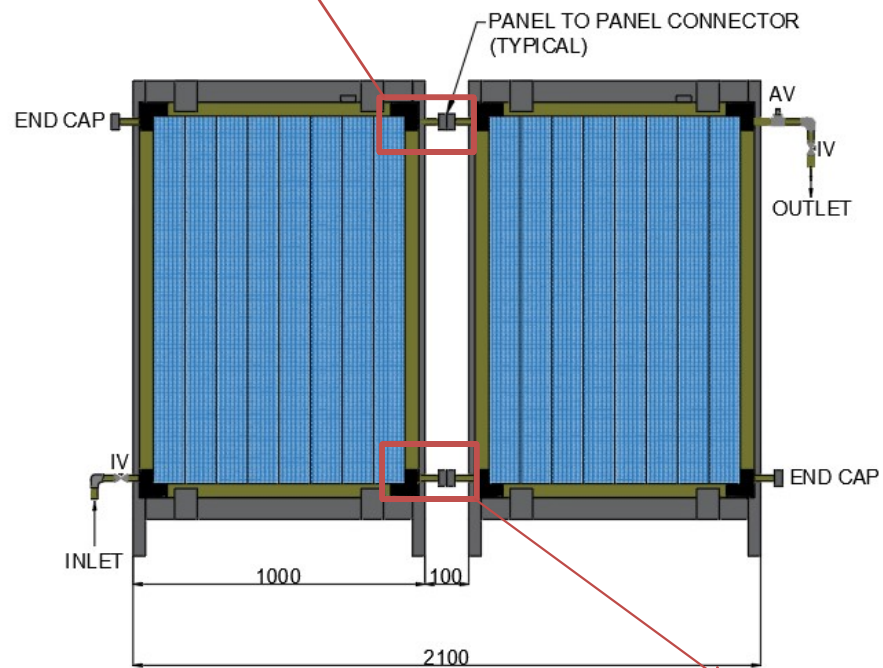
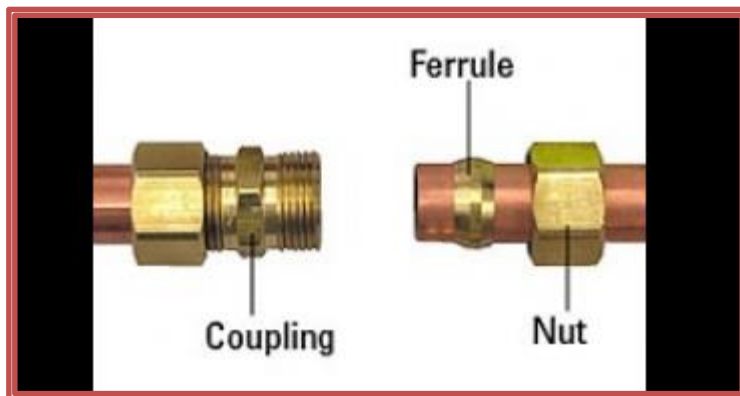

SOLAR PANEL SENSOR CONNECTION

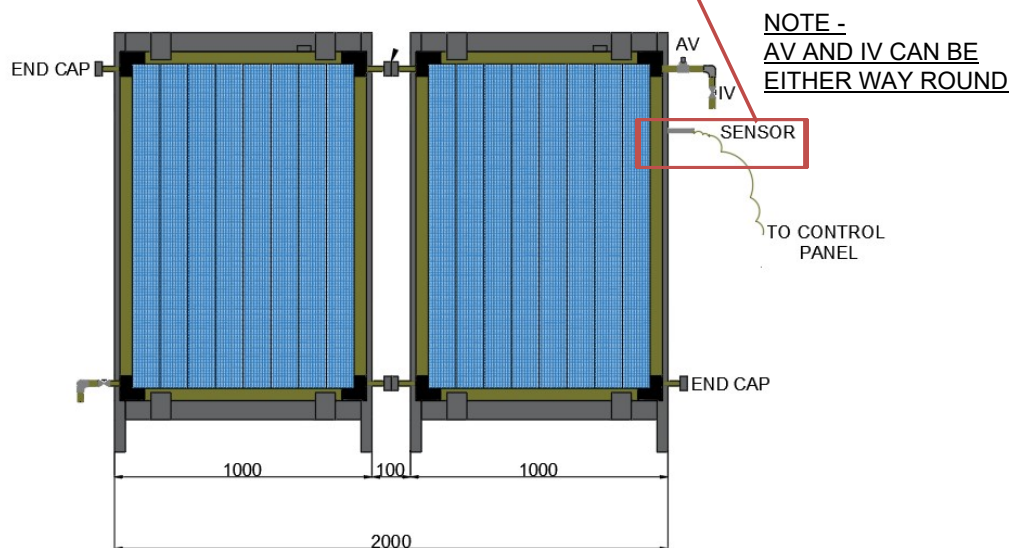

SOLAR CIRCULATION PUMP ASSEMBLY

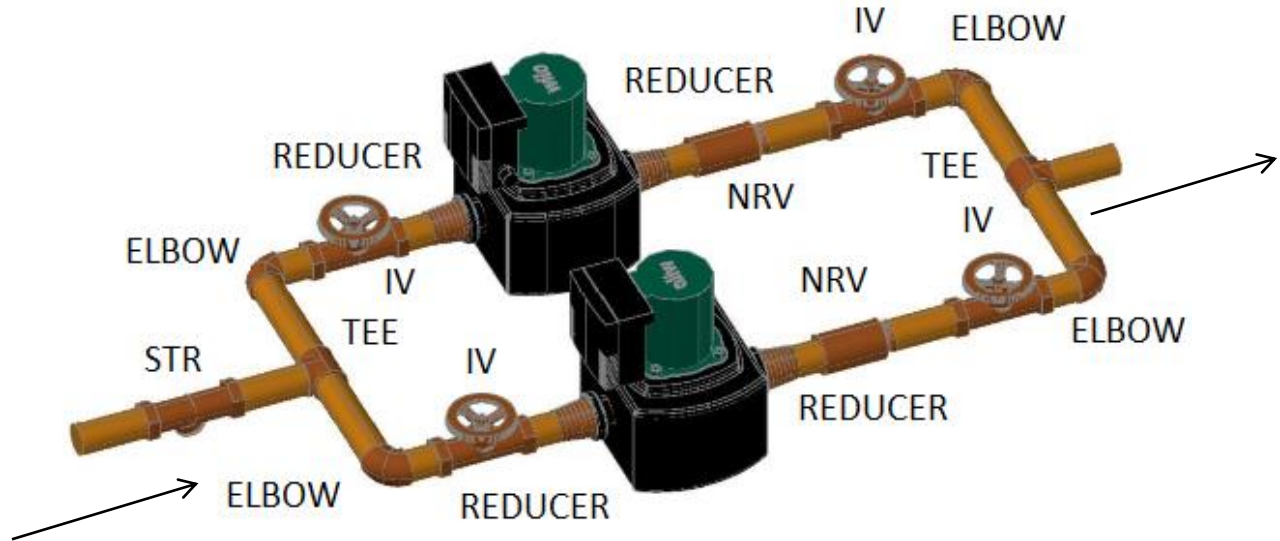

Number of Pumps		02 Nos	
Pipe Details		1" Pipe at 1 Length	
PUMP INLET (Common)			
SR. NO.	ITEM	SIZE	QTY
1	Strainer (STR)	1"	1
2	Socket	1"/28mm	1
3	Tee	28mm/28mm/1"	1
4	Elbow	1"	2
PUMP INLET			
1	Socket	1"	2
2	Isolation Valve (IV)	1"	2
3	Reducer	1-1/2"(F) / 1" (M)	2
PUMP OUTET			
1	Reducer	1-1/2"(F) / 1" (M)	2
2	Non Return Valve (NRV)	1"	2
3	Socket	1"/28mm	2
4	Isolation Valve (IV)	1"	2
5	Elbow	1"/28mm	2
6	Tee	28mm/28mm/1"	1

EXPANSION VESSEL ASSEMBLY

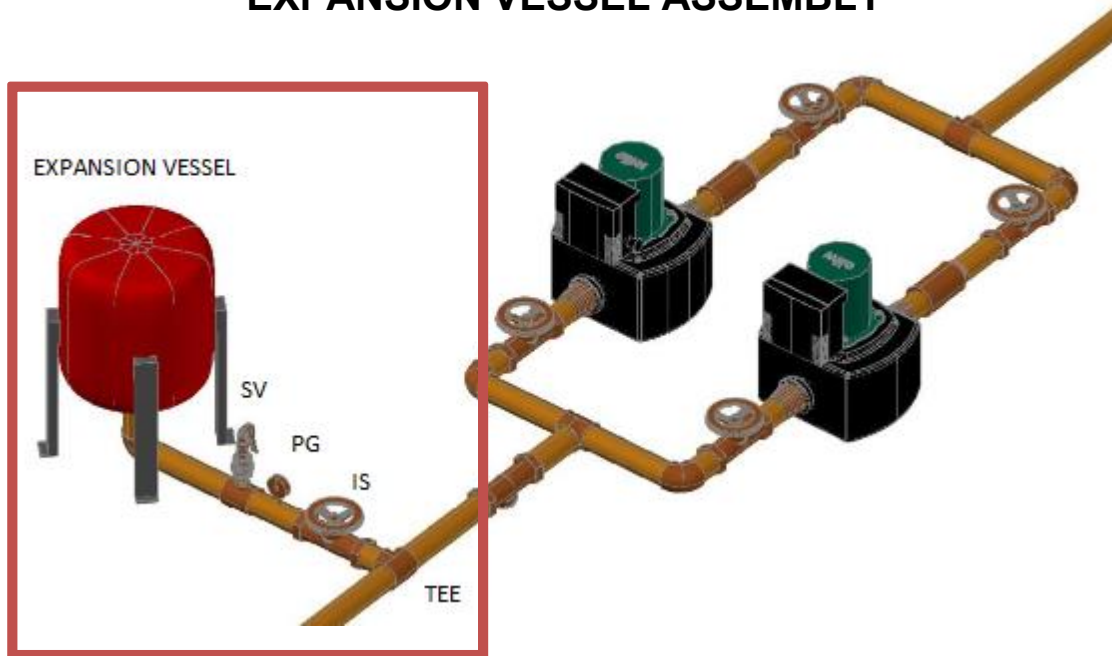

Number of Expansion Vessel		01 No.	
INLET			
SR. NO.	ITEM	SIZE	QTY
1	Isolation Valve (IS)	1"	1
2	Pressure Gauge (PG)	1"	1
3	Safety Valve (SV)	1"	1
Note:			
-Expansion Vessel to be Installed in the suction side of solar circulation pump			

EXPANSION VESSEL WITH PRE-COOL TANK ASSEMBLY

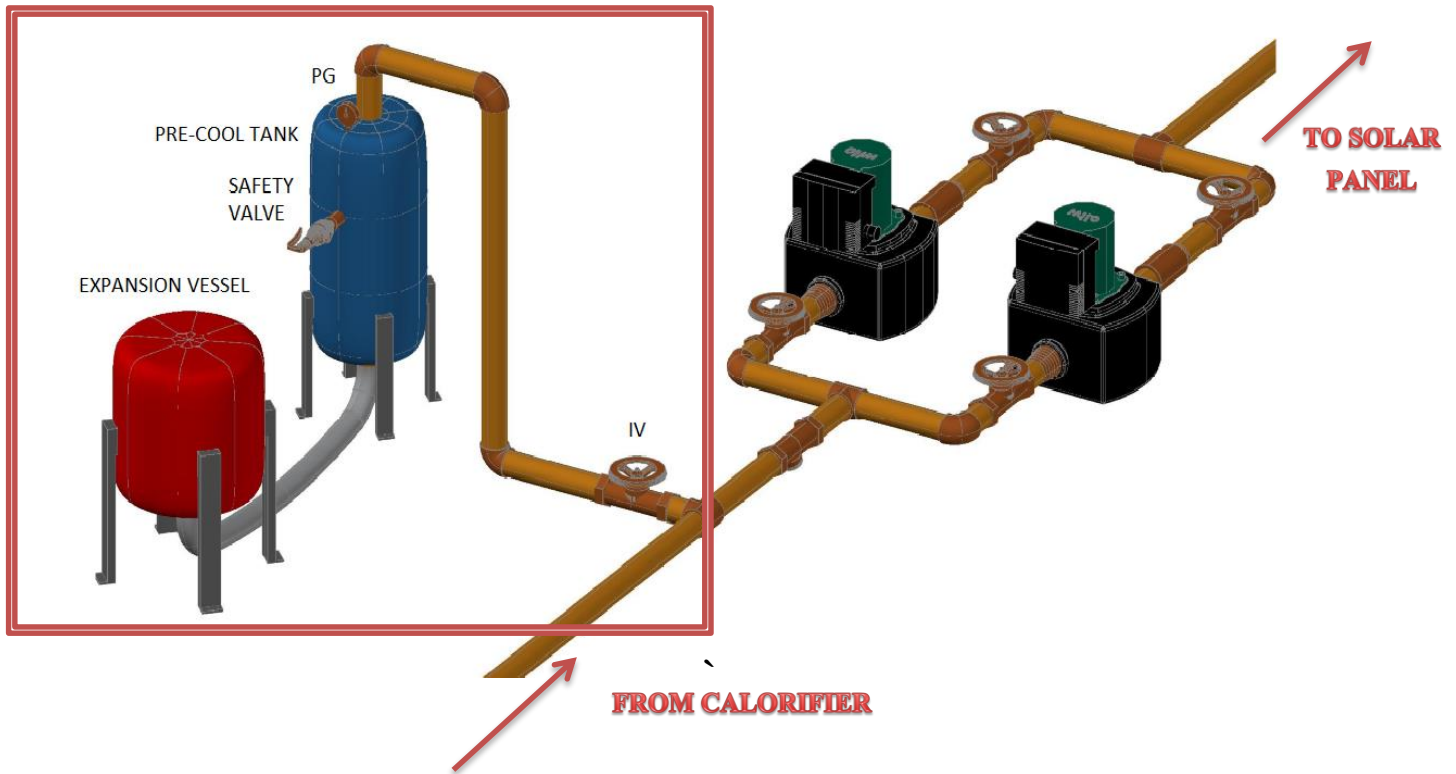

Number of Precool Tank		01 No.	
Number of Expansion Vessel		01 No.	
INLET			
SR. NO.	ITEM	SIZE	QTY
1	Isolation Valve (IS)	1"	1
2	Pressure Gauge (PG)	1"	1
3	Safety Valve (SV)	1"	1
Note:			
-Expansion Vessel to be Installed in the suction side of solar circulation pump			

EMERGENCY COOLER TANK ASSEMBLY

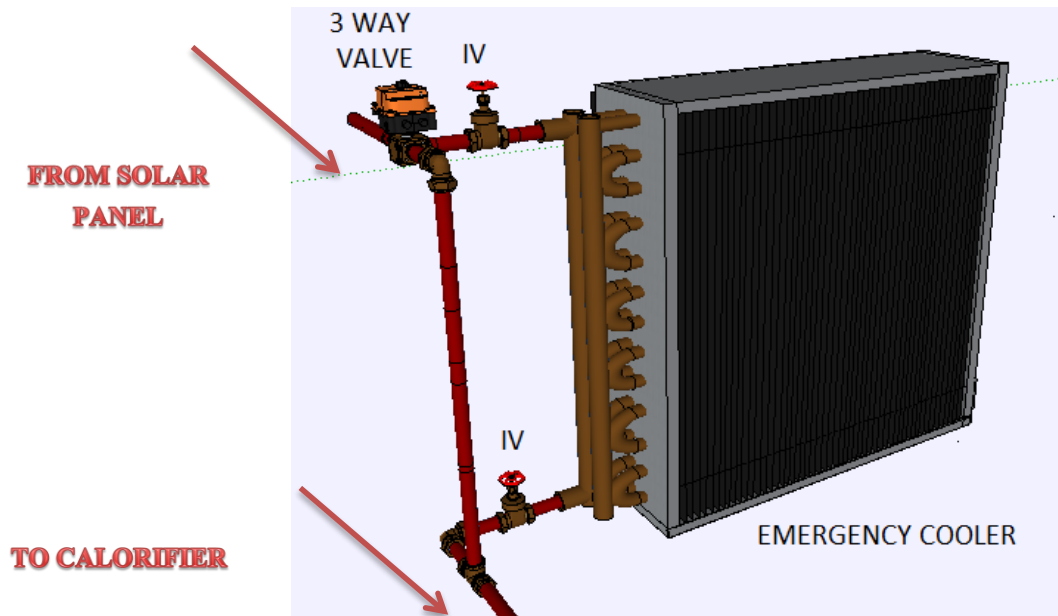

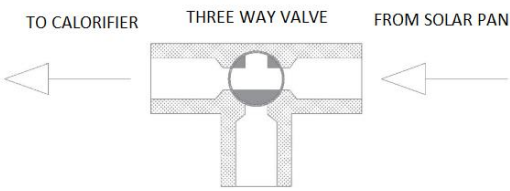
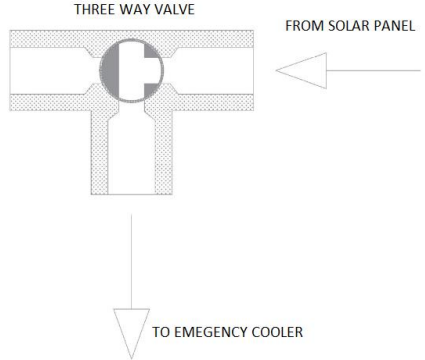
Number of Cooler		01 No.	
COOLER INLET			
SR. NO.	ITEM	SIZE	QTY
1	Three Way Valve		1
2	Isolation Valve		1
COOLER OUTLET			
1	Isolation Valve		1
Note: Three Way Valve Normal Operation		Note: Three Way Valve Cooling Operation	
			

FEEDER LINE ASSEMBLY

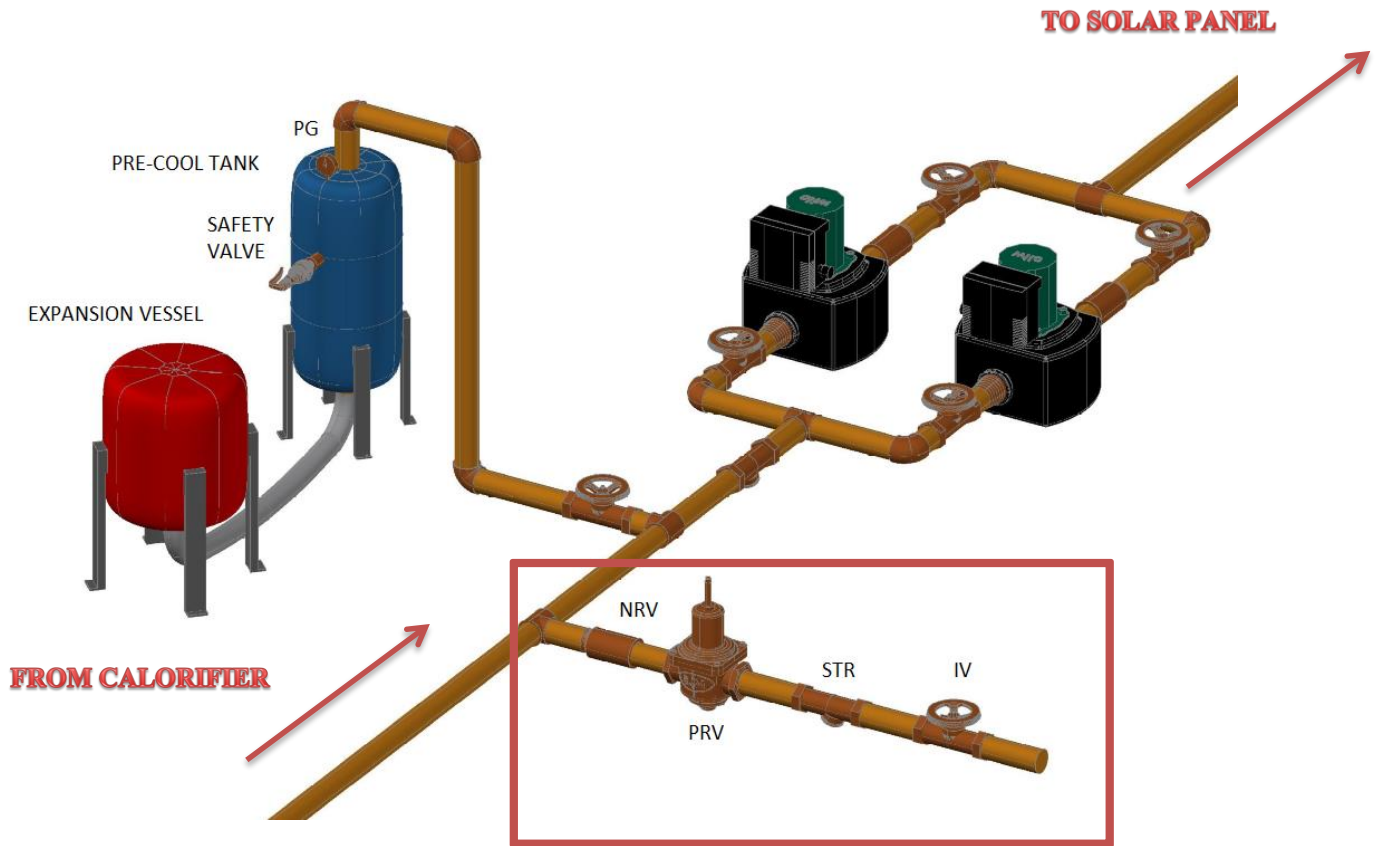

FEEDER LINE VALVES AND FITTINGS BOQ			
SR. NO.	ITEM	SIZE	QTY
1	Socket	1" / 28mm	1
2	Non Return Valve (NRV)	1"	1
3	Nipple	1"	1
4	Pressure Reducing Station (PRV)	1"	1
5	Nipple	1"	1
6	Strainer (STR)	1"	1
7	Nipple	1"	1
8	Isolation Valve (IS)	1"	1

NOTE:

-Primary/Solar Line Feeder Line should be installed at the suction side of the pump

CALORIFIER CONNECTIONS

MAGNESIUM ANODE



ANTI VACUUM VALVE



PRESSURE GAUGE



SENSOR

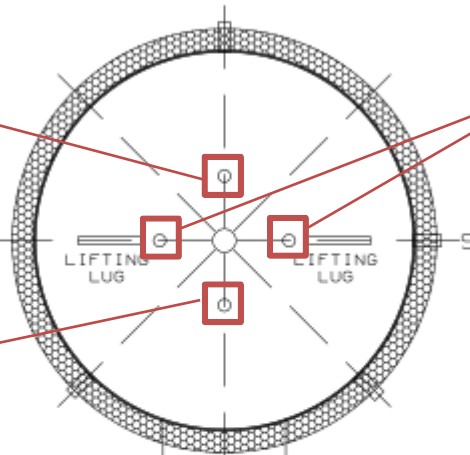

TOP CONNECTION
HOT WATER SUPPLY

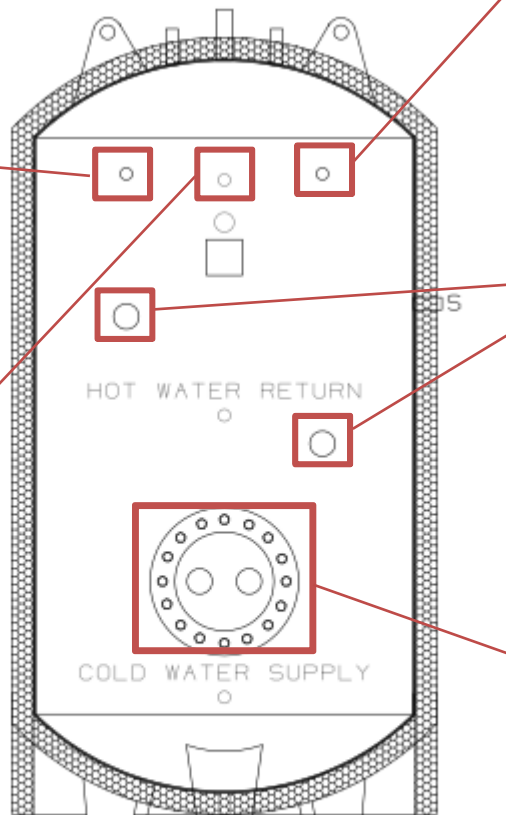

CONNECTION



SAFETY VALVE



TEMPERATURE GAUGE

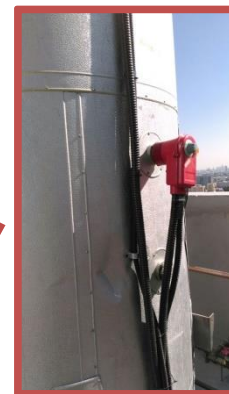

ELECTRIC HEATER

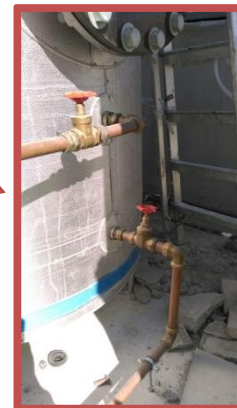

PRIMARY TOP INLET & BOTTOM OUTLET



Versol Poland | Versol Italy | Versol UK | Versol USA | Versol Middle East | Versol India

